

# DEC-TECHNICAL BULLETIN



Bulletin No: TB010 Version: v.01 Effective Date: 2021-05-13

Subject: **“STRIPPING IN” TECHNIQUE**

- Product  Pre-Installation  Installation  Repair  Maintenance  Other  
 External  Internal Use  Internal Use Only

**Target Audience:** All  
**Reason for Bulletin:** To provide installation instruction on how to perform the “Stripping In” technique for pre-installation of Dec-Tec membrane at the deck to wall transition.

**Details:**  
“Stripping In” refers to the installation of the membrane at the deck to wall transition (installing the membrane onto the wall) in advance of being able to fully install the membrane onto the horizontal surface. This installation technique is typically performed during new construction when there is a need to “close in” the dwelling by installing doors or to allow the builder to complete the installation of the buildings siding. This process allows the Dec-Tec installer to “Strip In” a piece of membrane that will allow other trades to complete their work. The installer can then come back at a latter date and complete the Dec-Dec installation.

**General consideration and recommendation:**

- Consult and comply with local building codes, typically the strip in piece of membrane should run min 6”- 8” up the wall and then out at least 6” onto the deck surface.
- Calculate the width required of the strip in piece, taking into consideration and how it will eventually meet up with the field membrane to form a seam. Remember the supplied width of Dec-Tec membrane is 76” so it is important to consider this along with the need for a 2” overlap.
- Install the strip in piece onto the vertical substrate using Solvent Based Adhesive. Refer to **CM-001 Basic Installation Guide – Wood Substrate V.03** for installation instructions.
- Do not apply adhesive onto sections of strip in piece of membrane that will not be fully installed at this time.
- With the strip in piece installed, the builder can now install doors and or siding onto the dwelling as desired.
- When it comes time to complete the Dec-Tec installation, consider the following:
  - Make sure the there are no dye lot issues with respect to the stripped in membrane and the field membrane.
  - Pre-fit the field membrane allowing for a 2” overlap with the installed stripped in membrane.
  - Complete the installation of the field membrane using Dec-Tec’s recommended procedures.

**Benefits of stripping in:**

1. For new construction, if stripping in technique is performed it can avoid the need for the doors or siding to be removed during the time of field membrane installation.
2. You can come back at any point in time to install field membrane and finish the job. It can buy you time and peace of mind.
3. If other trades need to be working on the deck, the stripping in technique allows them to complete their work without risk of damaging or compromising the field membrane which will be installed at a later date.

# DEC-TECHNICAL BULLETIN



**Siding installation**

Before

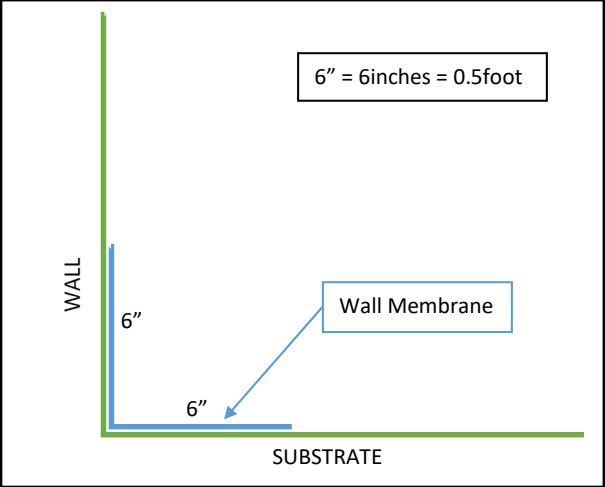

After

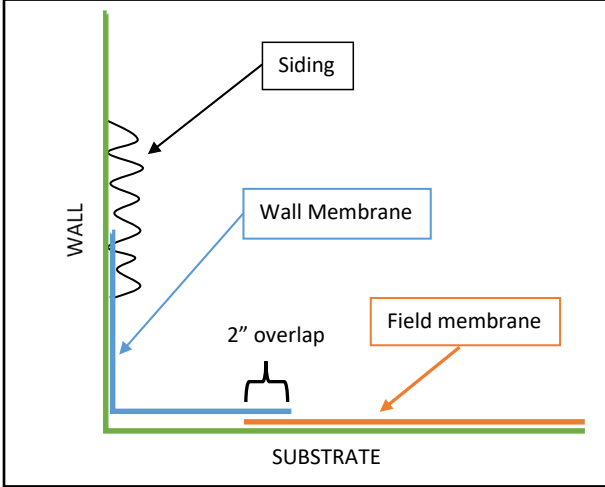

**Door installation**

Before

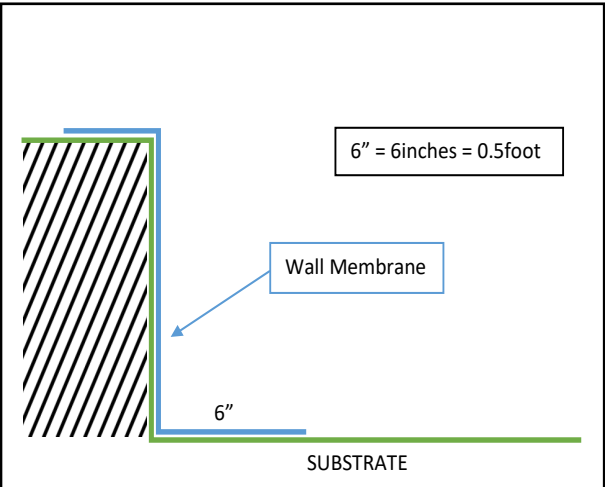

After

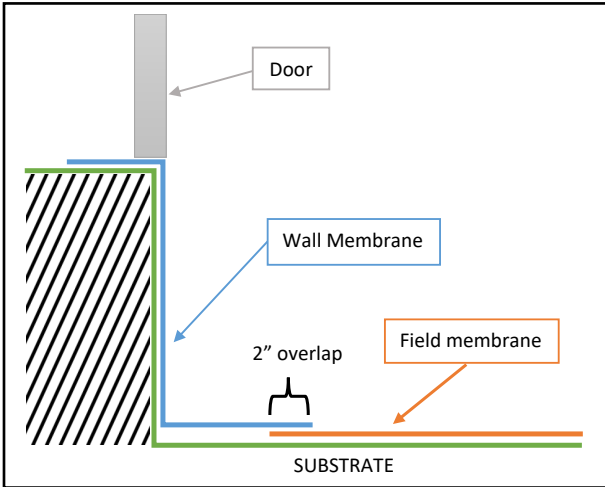

If you have any questions concerning this bulletin, please contact Dec-Tec, Technical Support at 1-866-461-3914.

DISCLAIMER: The information, illustrations, designs and recommendations contained in this document is confidential, privileged and only for the information of the intended recipient and may not be used, published or redistributed without the prior written consent of Skyline Building Systems Inc., The information and recommendations contained herein are offered as a service to our customers and are not intended to relieve the user from responsibility. The information and recommendations provided are believed by Skyline Building Systems Inc., to be accurate at the time of preparations or obtained by sources believed to be generally reliable. Skyline Building Systems Inc., makes no warranty concerning their accuracy and will not be liable for claims relating to any use regardless of whether it is claimed that the information or recommendations are inaccurate, incomplete or otherwise misleading. © Skyline Building Systems Inc., 2020